

# SWAM-BLASTER®

# Model MV-2 Abrasive Flow Component Chart

### ABRASIVE NOZZLE.

REFER TO THE SWAM-BLASTER ABRASIVE NOZZLE CHART FOR NOZZLE PART NUMBER

\* PRIMARY WEAR PARTS: Frequent inspection and replacement of these parts is necessary to assure proper operation of your SWAM-BLASTER and to prevent excessive wear of those parts which are not directly in the abrasive patch.

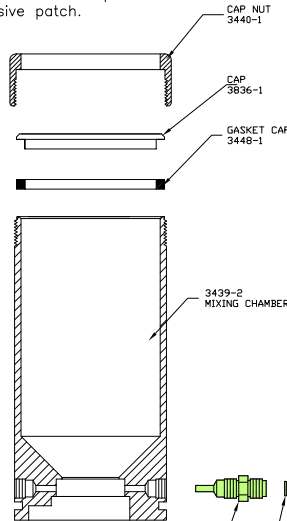

### ORIFICE PLATE ASSEMBLY

3462-1	8 HOLES	x	0.016	
3462-2	8 HOLES	x	0.026	
3462-2SS	8 HOLES	x	0.026	SS
3462-3	8 HOLES	x	0.032	
3462-4	16 HOLES	x	0.016	
3462-4C	16 HOLES	x	0.016	C'Sunk
3462-5	16 HOLES	x	0.026	
3462-5C	16 HOLES	x	0.026	C'Sunk
3462-6	16 HOLES	x	0.014	
3462-7	8 HOLES	x	0.011	
3462-8	16 HOLES	x	0.011	
3462-9	8 HOLES	x	0.040	
3462-10	16 HOLES	x	0.032	
3462-10C	16 HOLES	x	0.032	C'Sunk
3462-11	8 HOLES	x	0.060	
3462-12	8 HOLES	x	0.050	
3462-13	16 HOLES	x	0.040	

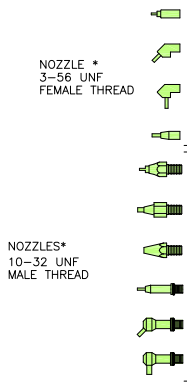
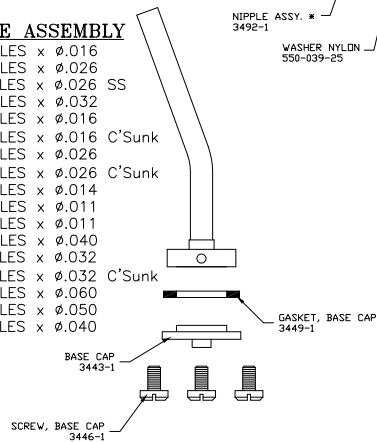

For components and their partnumber not shown on this chart, refer to your model MV-2/MV-2L operating and Maintenance Manual.

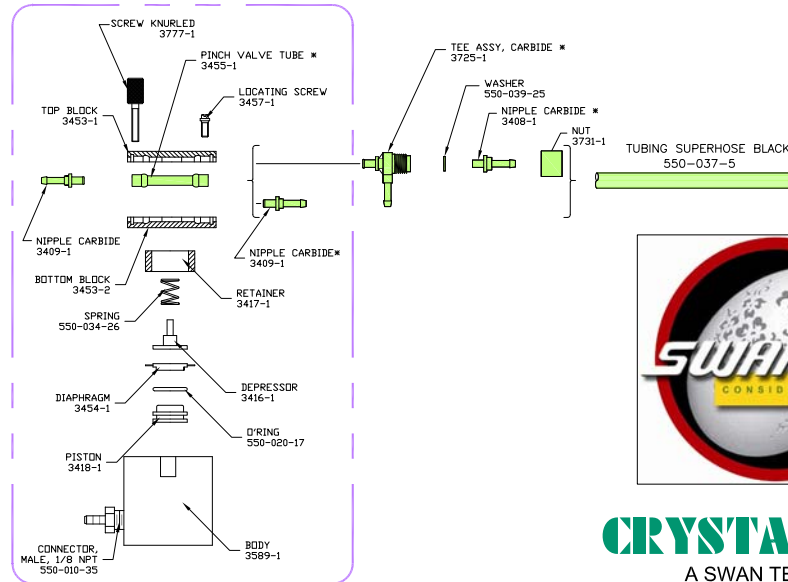
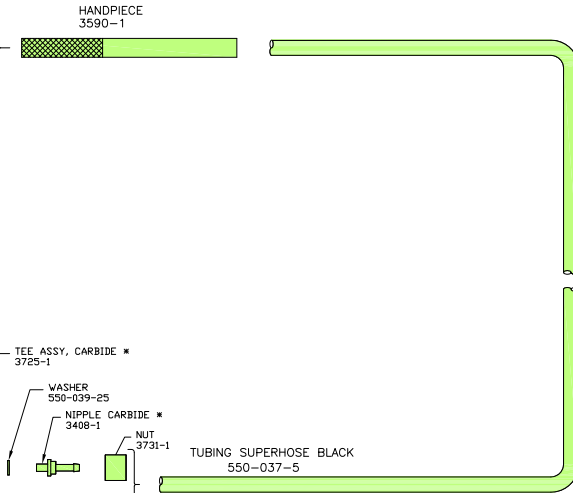

COMPLETE PINCH VALV ASSY.  
3717-1



**CRYSTAL MARK INC.**

A SWAN TECHNOLOGIES CORPORATION

613 Justin Avenue-Glendale, California 91201-2396

(818)240-7520 (800)659-7926 FAX (818)247-3574

www.crystallmarkinc.com-sales@crystallmarkinc.com

SWAM BLAST IS A TRADE MARK OF **CRYSTAL MARK INC.**